

Data sheet

Support roller NATR 6 PP (crowned, with axial guidance, cage, seal)

Designation	NATR 6 PP
Type	crowned
D [mm]	19
d [mm]	6
d1 [mm max.]	14
B1 [mm]	12
B [mm]	11
r [mm]	0,15
Dynamic load Crw[N]	3500
Static load C0rw[N]	3900
Speed limit [min-1]	20000
Speed limit [min-1]	20000

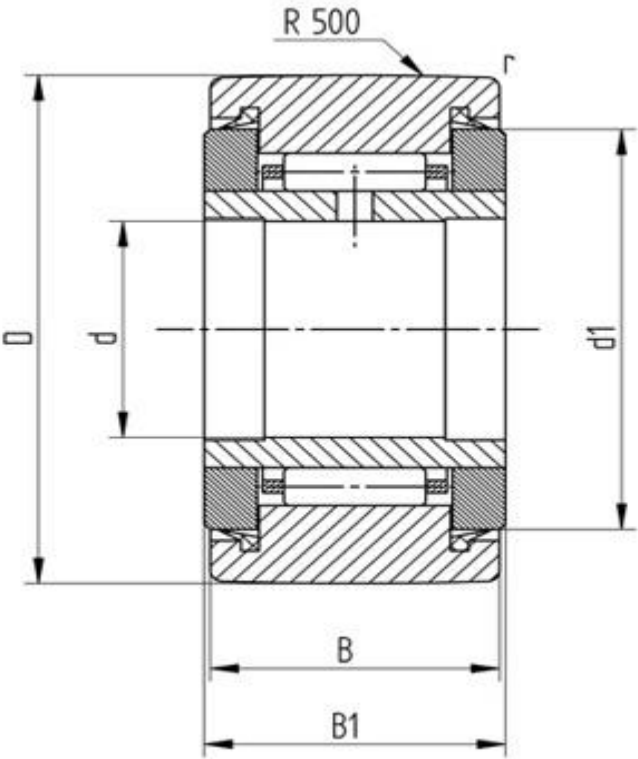

Every specification has been edited and verified carefully. STI Bearings GmbH assumes no liability for potential errors or incompleteness. Technical modifications are subject of changes.

© 2020 by STI Bearings GmbH

Reproduction, even excerpts, only with our approval.